

As conexões hidráulicas MECH são fabricadas em ferro fundido maleável, com padrão de rosca BSP e galvanizadas a fogo através do processo de zincagem por imersão a quente pela. Este método é realizado de acordo com os parâmetros estabelecidos pela NBR ABNT.

As conexões são projetadas para suportarem pressões internas de 10Mpa sob temperatura ambiente e são ideais para aplicação em redes hidráulicas de combate a incêndio. Também são muito utilizadas em sistemas voltados para o transporte de ar comprimido e vapor, pois atendem às aplicações para condução de fluidos sob pressão máxima de serviço de 2,5Mpa, em ambientes com temperaturas entre 120°C e 300°C e de 2,0Mpa sob a temperatura de 300°C.



**INFORMAÇÕES GERAIS**

Código	Modelo	Diâmetro (pol)	Diâmetro (mm)	Peso gramas	Dimensões (mm)			
					A	B	C	D
79289	Flange sextavada	1/2	15	174,2	80	5	15	28
79201		3/4	20	225,5	90	5,5	17	34
79202		1	25	326	100	6	19	41
79203		1.1/4	32	469	120	6,5	22	51
79204		1.1/2	40	630,8	130	7	22	57
79205		2	50	82,5	140	8	26	70
79206		2.1/2	65	1212,7	160	9	31	85
79269	Cotovelo de redução	3/4x1/2	20x15	94,2	30	31	15	18
79270		1x3/4	25x20	146,5	35	26	18	21
79223	Cruzeta	1/2	15	116,3	28	15	56	30
79224		3/4	20	203,4	33	18	66	36
79225		1	25	287,5	38	21	76	42
79226		1.1/4	32	460,9	45	26	90	52
79227		1.1/2	40	607,9	50	31	100	62
79228		2	50	971,2	58	34	116	68
79229		2.1/2	65	1404,2	69	42	138	84
79230		3	80	2105,2	78	48	156	96
79189	Te em 90°	1/4	8	48,7	21	11	42	22
79190		3/8	10	73	25	15	50	30
79187		1/2	15	95,3	28	45	56	90
79186		3/4	20	161,3	33	18	66	36
79181		1	25	238,9	38	21	76	42
79182		1.1/4	32	383,2	45	26	90	32
79183		1.1/2	40	504,8	50	31	100	62

Código	Modelo	Diâmetro (pol)	Diâmetro (mm)	Peso gramas	Dimensões (mm)				
					A	B	C	D	
79184	Te em 90°	2	50	828,2	58	34	116	68	
79185		2.1/2	65	1205,9	69	42	138	84	
79198		3	80	1772,4	78	48	156	96	
79199		4	100	2911,4	96	60	192	120	
79308	Te de redução	1.1/4x1/2	32x15	267,9	34	38	15	25	
79309		1.1/4x3/4	32x20	292,6	36	41	17	26	
79310		1.1/4x1	32x25	325,6	40	42	21	25	
79311		1.1/2x1/2	40x15	329,5	36	42	17	29	
79312		1.1/2x3/4	40x20	363,5	38	44	19	29	
79313		1.1/2x1	40x25	399,9	42	46	23	29	
79314		2x1/2	50x15	506,6	38	48	14	35	
79315		2x3/4	50x20	532,8	40	50	16	35	
79316		2x1	50x25	595,7	44	52	20	35	
79317		2x1.1/4	50x32	697,5	48	54	24	35	
79318		2.1/2x1	65x25	779,1	47	60	20	43	
79307		6	150	6932,4	131	91	262	182	
79110		Buchas de redução com flange	1x1/2	25x15	101	29	35	16	36
79143			2x1/2	50x15	320,3	35	48	33	65
79144			2x3/4	50x20	319,6	35	48	33	65
79145			2.1/2x1	65x25	664,6	40	54	37	80
79146	2.1/2x1.1/4		65x32	570,8	40	54	35	80	
79244	3x1/2		80x15	951,7	50	59	46	95	
79247	4x2		100x50	1503,8	51	69	45	120	
79248	4x2.1/2		100x65	1642,9	51	69	42	120	
79306	6x4		150x100	4193	58	87	56	175	
79208	Buchas de redução		3/8x1/4	10x8	17,3	20	10	19	---
79107		1/2x1/4	15x8	36,4	24	14	22	---	
79209		1/2x3/8	15x10	24,6	24	14	22	---	
79108		3/4x1/4	20x8	65,2	26	16	30	---	
79210		3/4x3/8	20x10	61,2	26	16	30	---	
79109		3/4x1/2	20x15	50,9	26	13	30	---	
79118		1x3/4	25x20	82,8	29	14	36	---	
79218		1.1/4x1/2	32x15	184,8	31	18	46	---	
79119		1.1/4x3/4	32x20	166,2	31	16	46	---	
79101		1.1/4x1	32x25	125,7	31	14	46	---	
79120		1.1/2x1/2	40x15	243,6	31	18	50	---	
79142		1.1/2x3/4	40x20	241,5	31	16	50	---	
79102		1.1/2x1	40x25	204,7	31	14	50	---	
79103		1.1/2x1.1/4	40x32	139,9	31	12	50	---	
79104		2x1	50x25	385,1	35	18	65	---	
79105		2x1.1/4	50x32	335,7	35	16	65	---	
79106		2x1.1/2	50x40	279,2	35	16	65	---	
79147		2.1/2x1.1/2	65x40	581,1	40	21	80	---	
79148		2.1/2x2	65x50	504,7	40	16	80	---	
79245		3x2	80x50	912,1	44	20	95	---	
79246		3x2.1/2	80x65	634,3	44	17	95	---	
79249		4x3	100x80	1276,5	51	21	120	---	
79197		União com assento cônico liga de bronze	1/2	15	173	48	41	22	---
79196			3/4	20	253	52	50	22	---

Código	Modelo	Diâmetro (pol)	Diâmetro (mm)	Peso gramas	Dimensões (mm)			
					A	B	C	D
79191	União com assento crônico liga de bronze	1	25	368	58	55	24	---
79192		1.1/4	32	519	65	70	27	---
79193		1.1/2	40	751	70	75	32	---
79194		2	50	944	78	90	30	---
79195		2.1/2	65	1644	85	110	31	---
79200		3	80	2065	95	130	35	---
79207		4	100	3645	110	150	38	---
79280	União com assento cônico liga de ferro	1/2	15	229	48	41	22	---
79281		3/4	20	283	52	50	22	---
79282		1	25	344	58	55	24	---
79283		1.1/4	32	587	65	70	27	---
79284		1.1/2	40	709	70	75	32	---
79285		2	50	1116	78	90	30	---
79286		2.1/2	65	1676	85	110	31	---
79287	3	80	2358	95	130	35	---	
79288	4	100	3366	110	150	38	---	
79160	Curva em 90° Macho/fêmea	1/2	15	102,4	55	48	42	---
79158		3/4	20	190,9	69	60	54	---
79131		1	25	301	85	75	68	---
79132		1.1/4	32	535,2	105	95	86	---
79133		1.1/2	40	691,1	116	105	97	---
79134		2	50	1196,9	140	130	116	---
79159		2.1/2	65	1891,3	176	165	149	---
79168	3	80	2972,1	205	190	175	---	
79169	4	100	5550,9	260	245	224	---	
79303	Cotovelo em 90° Macho/fêmea	1/4	8	35	21	28	11	---
79130		3/4	20	116	33	43	18	---
79304		1/2	15	73	28	37	15	---
79125		1	25	182	38	52	21	---
79126		1.1/4	32	293,6	45	60	26	---
79127		1.1/2	40	379	50	65	34	---
79128		2	50	623,6	58	74	34	---
79129	2.1/2	65	932,6	69	88	42	---	
79296	Cotovelo em 90° Fêmea	1/4	8	33,6	21	11	---	---
79297		3/8	10	68,3	25	15	---	---
79298		1/2	15	68,8	28	15	---	---
79149		3/4	20	116,4	33	18	---	---
79121		1	25	175	38	21	---	---
79122		1.1/4	32	277,7	45	26	---	---
79123		1.1/2	40	348,6	50	31	---	---
79124		2	50	600,5	58	34	---	---
79150		2.1/2	65	860,2	69	42	---	---
79299		3	80	1318,5	78	48	---	---
79300	4	100	2341	96	60	---	---	
79250	Cotovelo em 45°	1/4	8	33	18	8	---	---
79251		3/8	10	48,3	20	10	---	---
79252		1/2	15	78,1	22	9	---	---
79253		3/4	20	111,4	25	10	---	---
79254		1	25	156,1	28	11	---	---

Código	Modelo	Diâmetro (pol)	Diâmetro (mm)	Peso gramas	Dimensões (mm)			
					A	B	C	D
79255	Cotovelo em 45°	1.1/4	32	246	33	14	---	---
79256		1.1/2	40	328,7	36	17	---	---
79257		2	50	549,2	43	19	---	---
79258		2.1/2	65	782,2	50	23	---	---
79259		3	80	1225,5	55	25	---	---
79260		4	100	2347,1	66	30	---	---
79265	Niple duplo	1/4	8	31,8	36	19	---	---
79266		3/8	10	39,5	38	22	---	---
79167		1/2	15	50,4	44	27	---	---
79166		3/4	20	87	47	32	---	---
79161		1	25	114,4	53	41	---	---
79162		1.1/4	32	180,1	57	50	---	---
79163		1.1/2	40	215,6	59	55	---	---
79164		2	50	385,6	68	70	---	---
79165		2.1/2	65	609,4	75	85	---	---
79267		3	80	837,8	83	100	---	---
79268	4	100	1184,2	114	180	---	---	
79301	Niple duplo de redução	3/4x1/2	20x15	85,7	47	30	---	---
79302		1x3/4	25x20	129,5	53	36	---	---
79271	Curva em 90° fêmea	1/2	15	118,5	55	42	---	---
79272		3/4	20	216,9	69	54	---	---
79273		1	25	331,8	85	68	---	---
79274		1.1/4	32	588,5	105	86	---	---
79275		1.1/2	40	752,1	116	97	---	---
79276		2	50	1295,8	140	116	---	---
79277		2.1/2	65	2142,8	176	149	---	---
79278		3	80	3276,7	205	175	---	---
79279		4	100	5910,6	260	224	---	---
79231	Luva de redução	3/4x1/2	20x15	88	39	11	---	---
79305		1x1/2	25x15	105	45	15	---	---
79232		1x3/4	25x20	117	45	13	---	---
79261		1.1/4x1/2	32x15	159	50	18	---	---
79233		1.1/4x3/4	35x20	191	50	16	---	---
79234		1.1/4x1	32x20	180	50	14	---	---
79235		1.1/2x3/4	32x25	216	55	21	---	---
79236		1.1/2x1	40x20	225	55	19	---	---
79141		1.1/2x1.1/4	40x32	235	55	17	---	---
79237		2x1	50x25	393	65	24	---	---
79238		2x1.1/4	50x32	375	65	22	---	---
79239		2x1.1/2	50x40	381	65	22	---	---
79240		2.1/2x1	65x25	524	74	30	---	---
79241		2.1/2x1.1/4	65x32	509	74	28	---	---
79242		2.1/2x1.1/2	65x40	556	74	28	---	---
79243		2.1/2x2	65x50	626	74	23	---	---
79262		3x2	80x50	864	80	26	---	---
79263		3x2.1/2	80x65	828	80	23	---	---
79264		4x3	100x80	1369	94	28	---	---
79290		Luva paralela	1/4	8	26,5	27	7	---
79291	3/8		10	39,5	30	10	---	---

Código	Modelo	Diâmetro (pol)	Diâmetro (mm)	Peso gramas	Dimensões (mm)				
					A	B	C	D	
79157	Luva paralela	1/2	15	53,1	36	10	---	---	
79156		3/4	20	89,2	39	9	---	---	
79151		1	25	122,1	45	11	---	---	
79152		1.1/4	32	185,2	50	12	---	---	
79153		1.1/2	40	259,9	55	17	---	---	
79154		2	50	437,3	65	17	---	---	
79155		2.1/2	65	629,1	74	20	---	---	
79292		3	80	900,9	80	20	---	---	
79293		4	100	1481,2	94	22	---	---	
79211		Luva de correr dresser	1/2	15	379	93	---	---	---
79212	3/4		20	472	101	---	---	---	
79213	1		25	744	109	---	---	---	
79214	1.1/4		32	865	114	---	---	---	
79215	1.1/2		40	1037	118	---	---	---	
79216	2		50	1373	121	---	---	---	
79217	2.1/2		65	2004	137	---	---	---	
79170	Curva em 90° Macho	1/2	15	82	48	---	---	---	
79140		3/4	20	153	60	---	---	---	
79135		1	25	254	75	---	---	---	
79136		1.1/4	32	476	95	---	---	---	
79137		1.1/2	40	19,686	105	---	---	---	
79138		2	50	1056	130	---	---	---	
79139		2.1/2	65	1712	165	---	---	---	
79294		3	80	2613	190	---	---	---	
79295		4	100	5857	245	---	---	---	
79177		Tampão	1/4	8	20,2	15	---	---	---
79178	3/8		10	27,7	17	---	---	---	
79179	1/2		15	43,1	19	---	---	---	
79176	3/4		20	67,7	22	---	---	---	
79171	1		25	91,7	24	---	---	---	
79172	1.1/4		32	136,4	27	---	---	---	
79173	1.1/2		40	182,6	27	---	---	---	
79174	2		50	301,2	32	---	---	---	
79175	2.1/2		65	445,4	35	---	---	---	
79180	3		80	629,8	38	---	---	---	
79188	4		100	1345,2	45	---	---	---	
79219	Bujão		1/4	8	12,8	14	---	---	---
79220			3/8	10	21,9	15	---	---	---
79117		1/2	15	22,7	18	---	---	---	
79116		3/4	20	45,7	20	---	---	---	
79111		1	25	58,7	23	---	---	---	
79112		1.1/4	32	127,7	29	---	---	---	
79113		1.1/2	40	146,9	30	---	---	---	
79114		2	50	241	36	---	---	---	
79115		2.1/2	65	396,2	39	---	---	---	
79221		3	80	628,3	44	---	---	---	
79222		24	100	1038,9	58	---	---	---	

Referência: Cotovelo de redução

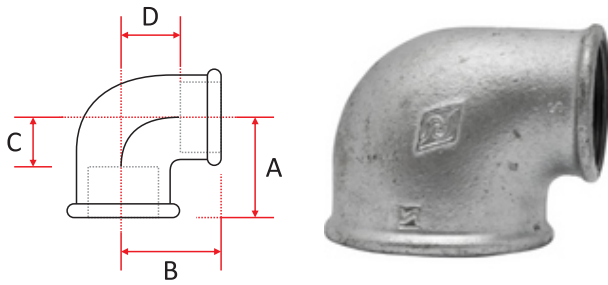

Referência: Cruzeta

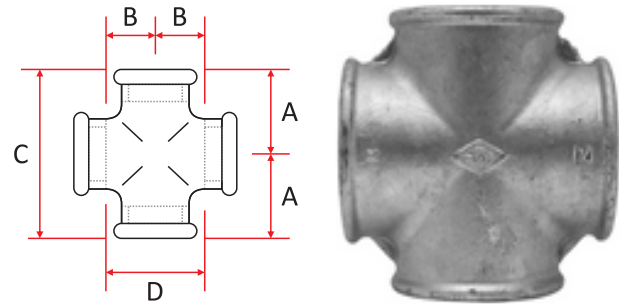

Referência: Tê em 90°

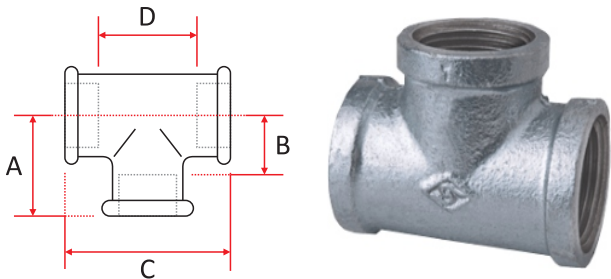

Referência: Tê de redução

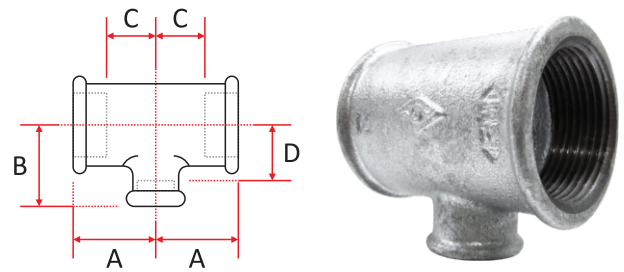

Referência: Bucha de redução com flange

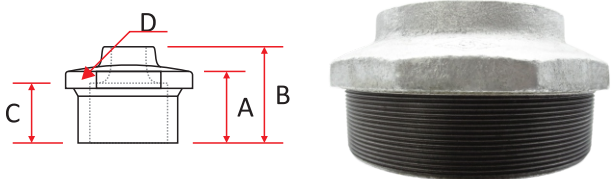

Referência: Bucha de redução

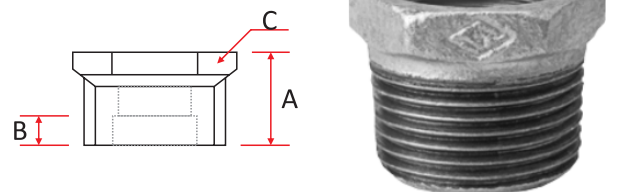

Referência: Flange Sextavada

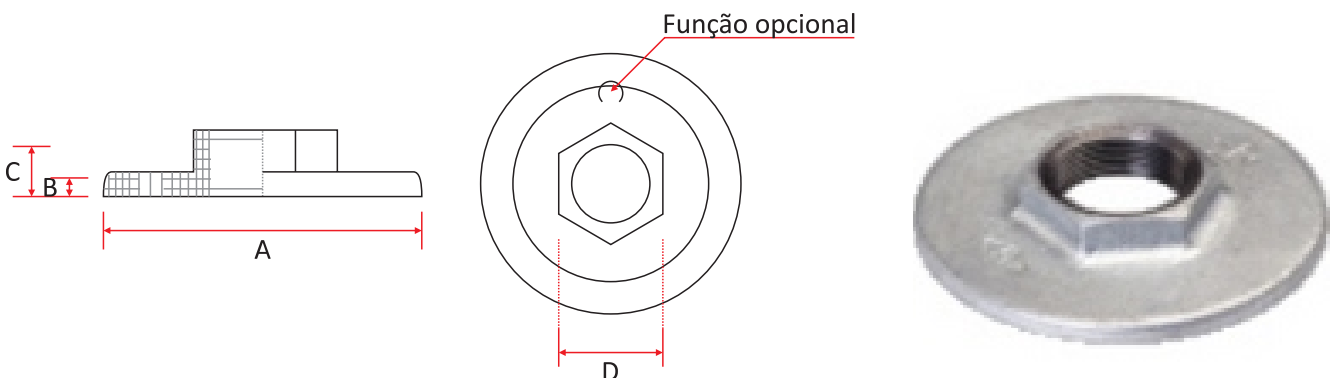

Referência: Curva em 90° macho/fêmea

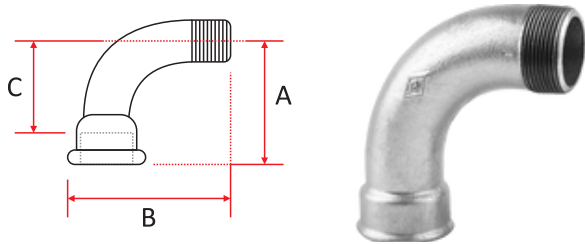

Referência: Cotovelo em 90° macho/fêmea

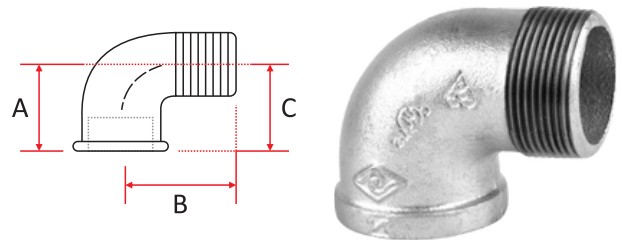

Referência: Cotovelo em 90° fêmea

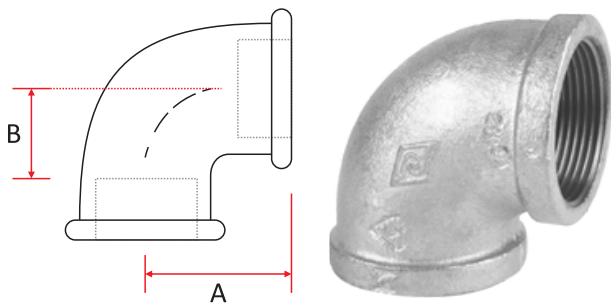

Referência: Cotovelo em 45°

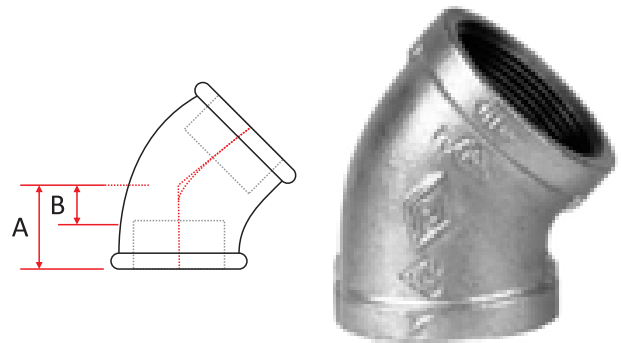

Referência: Niple duplo

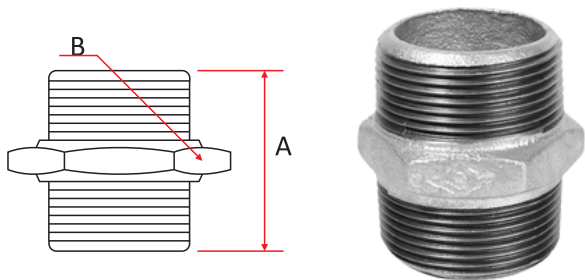

Referência: Niple duplo de redução

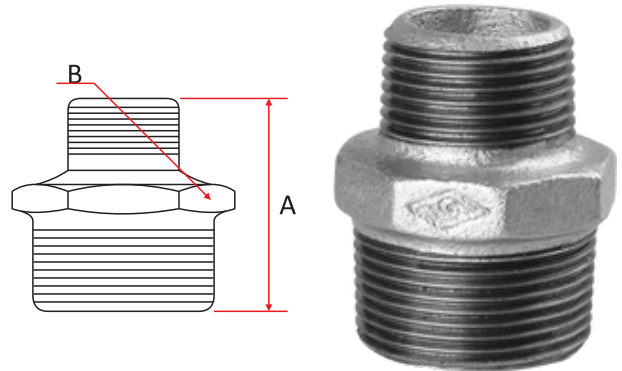

Referência: União de Assento cônico liga de bronze e União de Assento cônico com liga de ferro



Referência: Curva em 90° fêmea

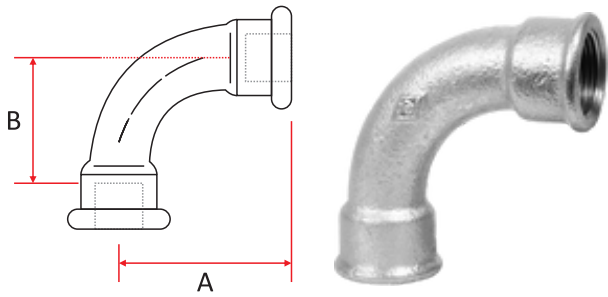

Referência: Luva de redução

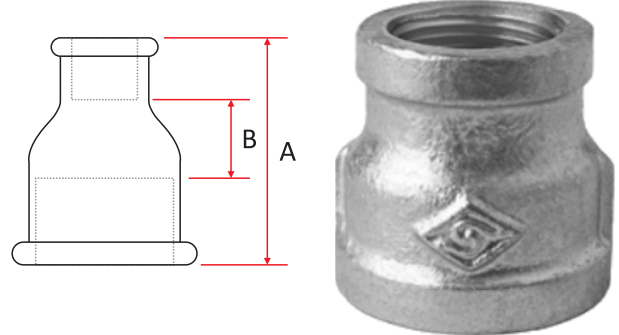

Referência: Luva paralela

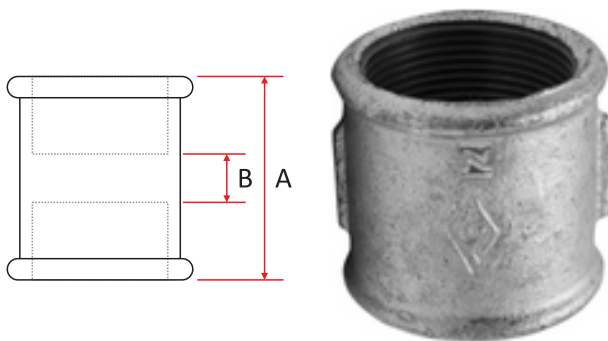

Referência: Luva de correr dresser

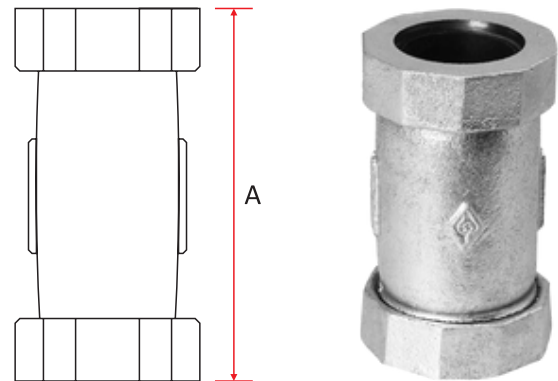

Referência: Curva em 90° macho

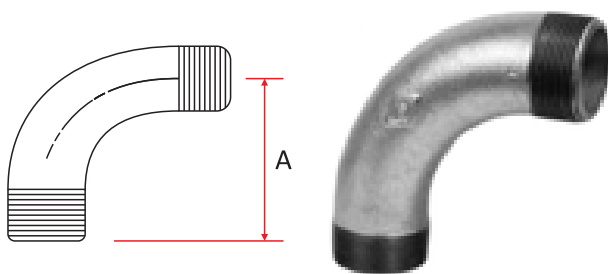

Referência: Bujão

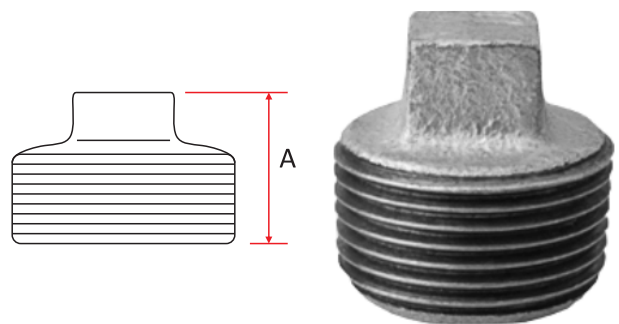

Referência: Tampão

